



MODEL IDS604-SS Series

SDS Load cell

SDS LOAD CELL
HIGH PRECISION
& PERFORMANCE

Features

- Single point bench scale
- Stainless steel construction
- Japanese technology applied
- Special rubber for high humidity protection
- Special silicone for surface coating



Specification

PARAMETER	VALUE	UNIT
Capacity	10,15,30,60,100,150,300	kg
Rated output	2 ± 0.2	mV/V
Zero balance	± 0.05	mV/V
Input resistance	385 ± 10	Ohms
Output resistance	350 ± 3	Ohms
Non linearity	± 0.012	% R.O.
Hysteresis	± 0.012	% R.O.
Non-repeatability	0.01	% R.O.
Creep	± 2	$\mu V / 12V / 80 \% R.O./1min$
Zero shift	± 2	$\mu V / 12V / 80 \% R.O./1min$
Power on stability	± 2	$\mu V / 12V / 2 min$
Temperature effect on zero	± 0.05	% R.O / 10 °C
Temperature effect on rated output	± 0.02	% R.O / 10 °C
Excitation recommended	5~15	V
Safe overload	150	% R.O.
Insulation resistance	$\geq 5000 (50 VDC)$	Mega-Ohms
Cable , Length	$\varnothing 5 \text{ mm} \times 1.7 \text{ m.}$	

All specifications listed are subject to change without notice.

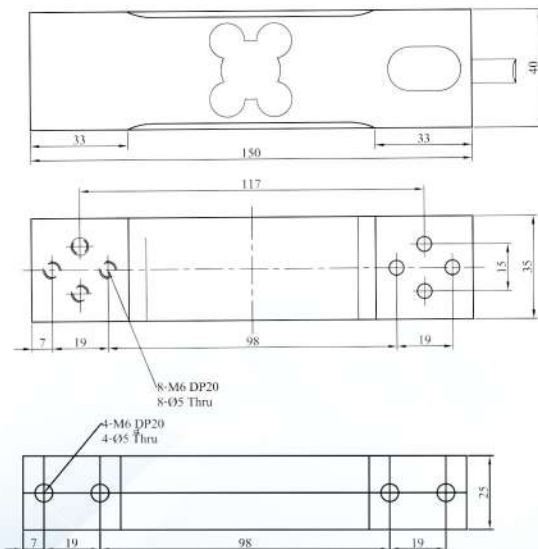

For 60kg - 300kg

For 10kg - 30kg

Color code of cable

